

INSTRUMENT CALIBRATION

MAY 15, 2000

SNY, 60°

M. VAN FOSSEN
T. DE CHELBOE

LOCATION: KANSAS - INDIAN
COUNTY TRAP SHOOTERS ASSOC -
USGS BASE LINE / CALIBRATION
LINE - SEE 20, DEWY TRAP

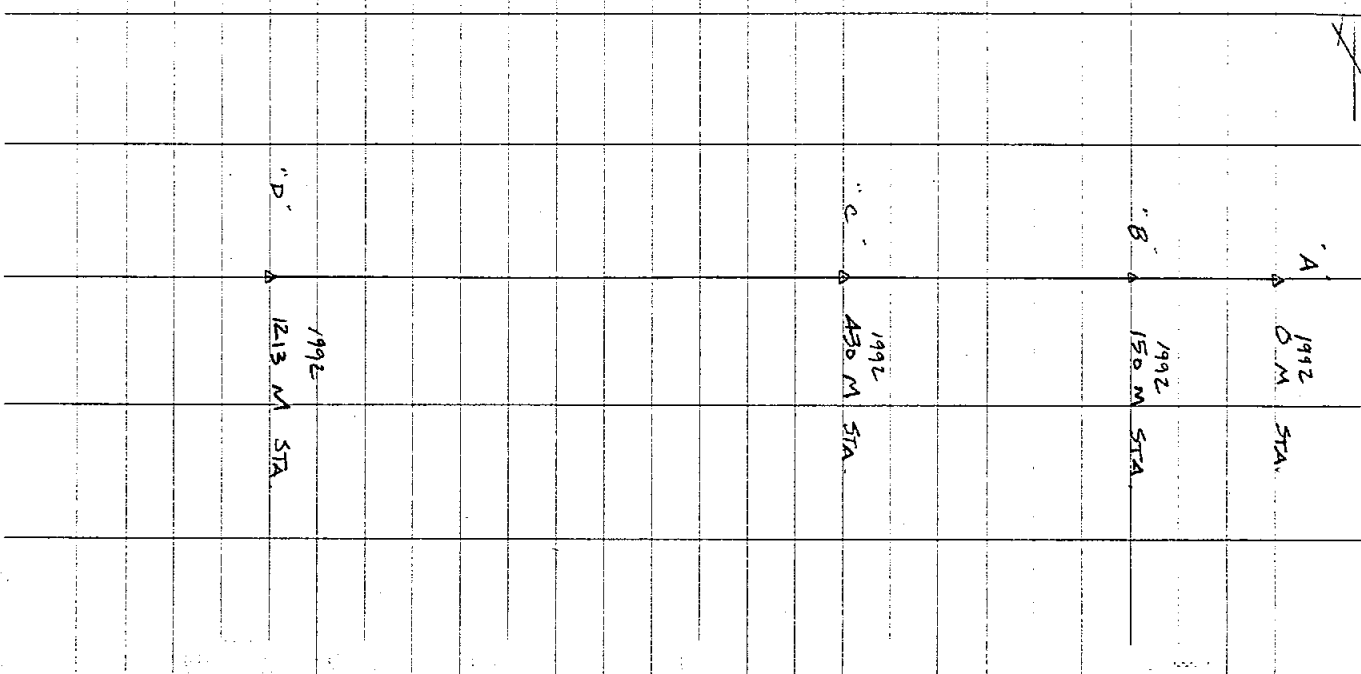

THEODOLITE: WILD T1000 F. No. 360337
 EDM : WILD DI 1001 #101937
 PRISM : WILD SR 1

A B :

BA = D = 492.44 M 150.006 M

E = 150.006 M

D = 150.005 M

E = 150.006 M

B C = D = 280.009 M

E = 280.010 M

D = 280.009 M

E = 280.010 M

A C :

CD = D = 783.364 M

R = 783.362 M

D = 783.376 M

R = 783.370 M

INSTRUMENT CALIBRATION

MAY 8, 2000

SUNNY 82°F

T. SINVAQUE
K. CONG

LOCATION: Mason - Alabama
County Trap Shooters Assoc. -
USGS Base Line / Calibration
Line. See 20 Velocity Trap.

Δ FOUND NGS DISK IN CONCRETE

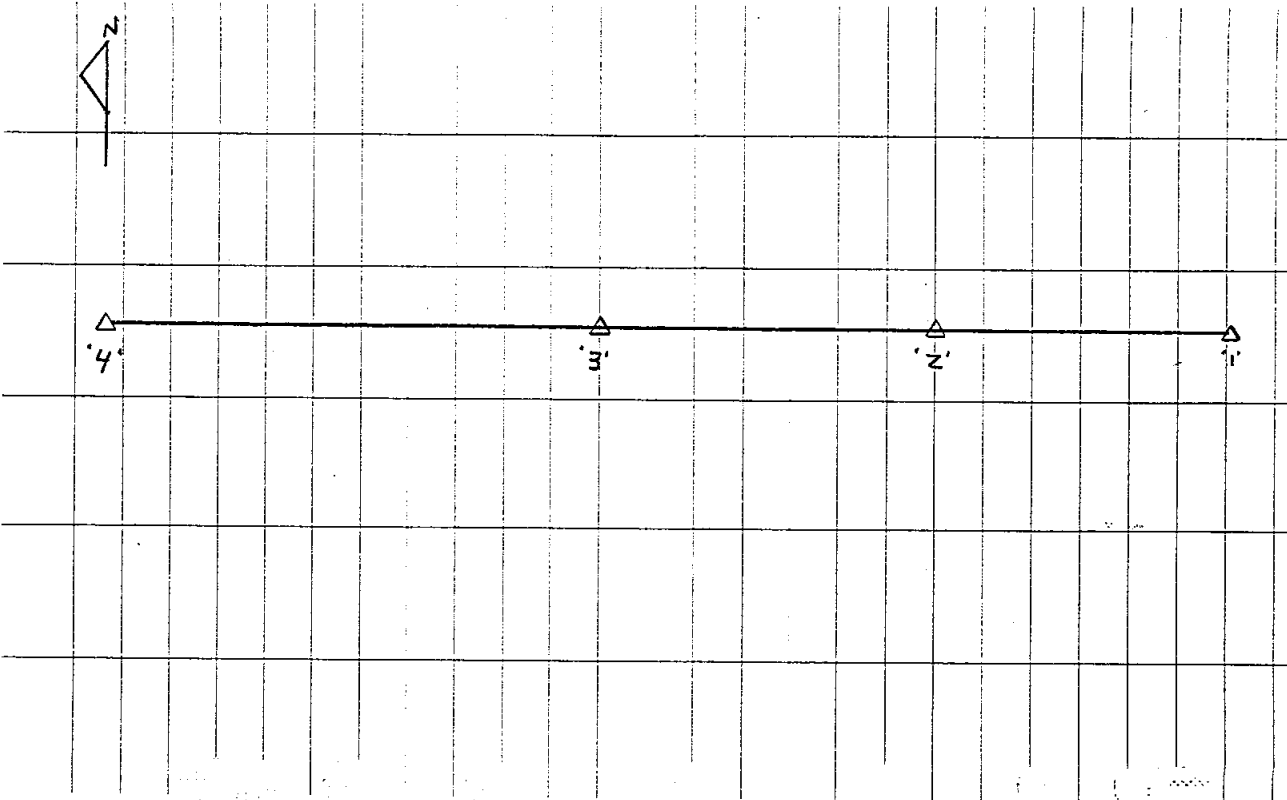

<u>12</u>	D = 149.9985								
	R = 149.9985								
	D = 149.9985								
	R = 149.9985								
									149.9985
<u>13</u>	D = 429.9932								
	R = 429.9942								
	D = 429.9951								
	R = 429.9962								
									429.9944
<u>14</u>	D = 1213.3526								
	R = 1213.3546								
	D = 1213.3586								
	R = 1213.3676								
									1213.3584
THEODOLITE LEICA TOPO SW 366561 GOM WILD D11001 SN 103428 <u>12 AND 13 WERE SHOT USING A</u> <u>SINGLE WILD PRISM</u>									

