



4-153

153

COUNTY SURVEYOR'S RECORD.

TOWN *Dearborn* NORTH, RANGE *One* East, MERIDIAN OF MICHIGAN.

SEC. 8

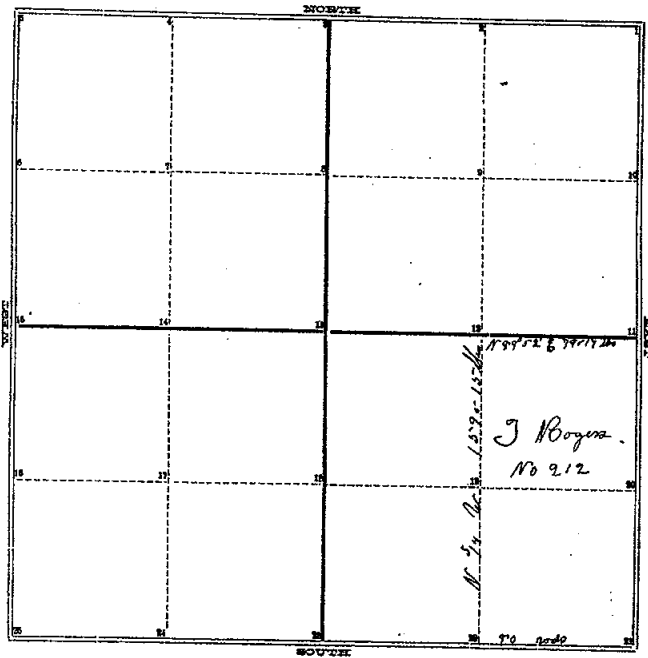

Dec 21

TOWN *Dearborn* NORTH, RANGE *One* East, MERIDIAN OF MICHIGAN.

- 1
- 2
- 3
- 4
- 5
- 6
- 7
- 8
- 9
- 10
- 11 *Marsh*
- 12 *Marsh*
- 13
- 14
- 15
- 16
- 17
- 18
- 19
- 20
- 21 *Marsh*
- 22 *Marsh*
- 23

Run by the true Meridian Nov 3/4 18 Surveyed and Recorded July 15th 1842  
 by A Jackson Co Surveyor

4-388

COUNTY SURVEYOR'S RECORD,

TOWN *Law* NORTH, RANGE *One East*, MERIDIAN OF MICHIGAN.

SEC. 16

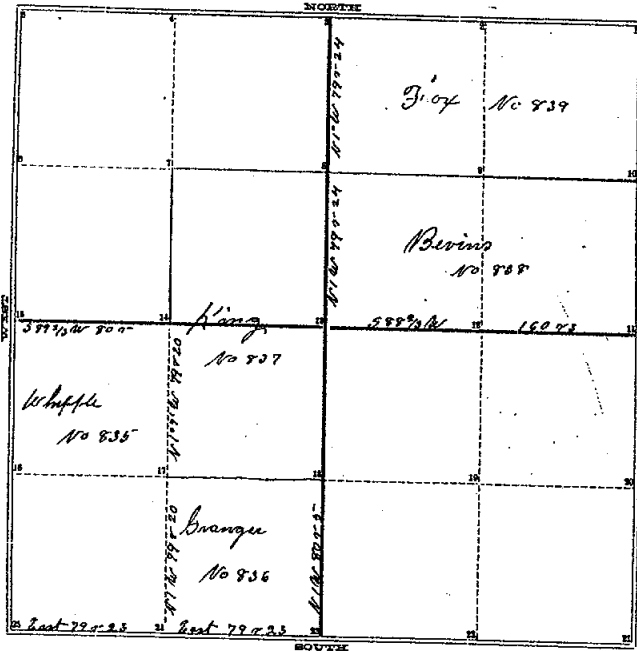

7. The field notes in survey No 835 have  
 been revised since 1st of June 20th '90  
 & the original field notes have been  
 being 3.11.11 compared April 19th 1900  
 J. J. Brown Geo. Surveyor

P 234.11.2

TOWN *Law* NORTH, RANGE *One East*, MERIDIAN OF MICHIGAN.

- 12 Survey 8 551 W 6 1/2
- 13 Dubh 11 5 35 8 17
- 8 Elm 16 5 22 W 25
- 9 Beck 17 5 50 8 25
- 4
- 5
- 6
- 7 Jan 18 N 55 1/2 E 13
- 17 Do 7 North 8 1/2
- 8 Ach 7 5 52 W 24
- 9 Meph 6 5 9 6 10 1/2
- 9 Meph 24 5 72 1/2 E 101 1/2
- 10 Sup. Oct 24 8 55 3/4 W 120
- 11 Sup 16 5 17 6 20
- 12 Beck 30 N 5 6 31
- 13 W Oak 12 5 54 1/2 56 1/2
- 14 W Oak 22 N 84 1/2 W 34
- 15 W Oak 12 N 11 1/2 E 12 1/2
- 16 Ach 7 5 26 6 5
- 17 W Oak 11 5 2 1/2 16
- 18 Ach 9 5 56 W 27
- 16 N Oak 10 N 38 1/2 E 59 1/2
- 17 D O 15 N 23 3/4 18
- 18 Beck 16 5 27 8 97
- 19 W Oak 22 5 77 1/2 W 37
- 19
- 20
- 21
- 22
- 23 Elm 24 5 74 W 47 1/2 T
- 24 S mgn 20 5 58 1/2 W 64

Jan 16 N 15 8 18  
 L 22 D O 6 5 56 8 5  
 M 28

Revised by the Town Recorder Nov 2 75 E  
 Deleted and Replaced Jan 2 on 18 93  
 By A Jackson Geo Surveyor

Note: This record seems to be a little mixed up