

LAND CORNER RESTORATION CERTIFICATE

FILING REQUIREMENT OF ACT 74, MICH. P.A. 1970

LIBER **1 PG 395**

FOR CORNERS OF--:	LOCATED IN--:	CORNER CODE NUMBER
1. PUBLIC LAND SURVEY <u>34</u> T. <u>4</u> N. <u>8</u> R. <u>2</u> E. W.		<u>I-12, I-13</u>
2. PROPERTY CONTROLLING IN SECTION _____, T. _____, S., R. _____, E. W.		
3. MISCELLANEOUS PROPERTY IN SECTION _____, T. _____, S., R. _____, E. W.		
4. LOT NO. _____, RECORDED PLAT _____		
5. PRIVATE CLAIMS _____		

FILED

MAR 27 1 56 PM '72
REGISTER OF DEEDS
Min Bill Henry
INGHAM COUNTY, MICH.

REGISTER OF DEEDS STAMP AND FILING NUMBER

I, OSCAR BOSS do hereby certify that under requirements of P.A. 74, Michigan P.A. of 1970, the corner points mentioned in lines 1 and 2 above (identified with circles on index code diagram - over) were, in a field survey on JULY 20 1971, established, re-established, monumented, re-monumented, recovered or restored as expressed below and in conformance with regulations and rules therefore as required in the current manual of survey instructions of the United States Department of the Interior, Bureau of Land Management or by a decree of a court of law. Furthermore, that the corner points mentioned in lines 3, 4 and 5 above were, in a field survey on _____ 19____, found, recovered, restored, established or re-established as expressed below and in conformance with the rules of the Michigan State Board of Registration for Land Surveyors or, by a Decree of a Court of law:

A. Description of original monument and accessories and/or subsequent restoration:

I-12: UNKNOWN
I-13: UNKNOWN

B. Description of corner evidence found and/or method applied in restoring or re-establishing corner:

I-12: SET: P.K. NAIL
EXISTG. OCCUPATION EVIDENCE
IN RE-ESTABLISHING CORNER
I-13: FOUND 1/2" IRON

C. Description of monument for corner and accessories established to perpetuate locating the position of the corner:

I-12: P.K. NAIL
N.W. - 64.4 - BLACK & WHITE HIGHWAY POST
S.E. - 14.63 - NORTH LEG OF ARROW SIGN
S.E. - 63.4 - POWER POLE ANCHOR POST
S.W. - 93.3 - WEBBERVILLE RD. ROWLEY ST. SIGN
S.W. - 103.9 - POWER POLE
I-13: 1/2" IRON
N.E. - 35.9 - STEEL STREET SIGN
S.E. - 89.0 - 36" MAPLE
S.W. - 113.3 - 36" MAPLE

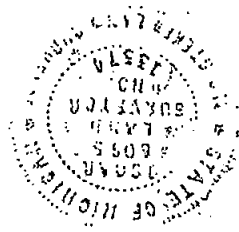

SIGNED BY Oscar Boss DATE March 10, 1972

SURVEYOR'S MICHIGAN REGISTRATION NO. 13574 (SEAL)

FOR STATE AND UNITED STATES AGENCIES:

SIGNED BY _____ CHIEF OF SURVEY PARTY DATE _____

APPROVED AND SIGNED BY _____ MICHIGAN REGISTERED LAND SURVEYOR DATE _____ (SEAL)

198

SURVEYOR'S MICHIGAN REGISTRATION NO. _____

LAND CORNER RECORDATION CERTIFICATE

FILING REQUIREMENT OF ACT 74, MICH. P.A. 1970

LIBER

2 PG 47

FOR CORNERS OF--	LOCATED IN--	CORNER CODE NUMBER
1. PUBLIC LAND SURVEY <u>2</u> T. <u>3</u> N. <u>5</u> R. <u>2</u> E. <u>W.</u>		<u>K-1</u>
2. PROPERTY CONTROLLING IN SECTION _____ T. _____ N. _____ R. _____ E. _____ S. _____ W. _____		
3. MISCELLANEOUS PROPERTY IN SECTION _____ T. _____ N. _____ R. _____ E. _____ S. _____ W. _____		
4. LOT NO. _____, RECORDED PLAT _____		
5. PRIVATE CLAIMS _____		

FILED
AUG 28 12 29 PM '72
REGISTER OF DEEDS
Carroll M. Lewis
INGHAM COUNTY, MICH.
REGISTER OF DEEDS STAMP AND FILING NUMBER

I, OSCAR BOSS do hereby certify that under requirements of P.A. 74, Michigan P.A. of 1970, the corner points mentioned in lines 1 and 2 above (identified with circles on index code diagram-over) were, in a field survey on AUGUST 11, 1972, established, re-established, monumented, re-monumented, recovered or restored as expressed below and in conformance with regulations and rules therefore as required in the current manual of survey instructions of the United States Department of the Interior, Bureau of Land Management or by a decree of a court of law. Furthermore, that the corner points mentioned in lines 3, 4 and 5 above were, in a field survey on _____ 19____, found, recovered, restored, established or re-established as expressed below and in conformance with the rules of the Michigan State Board of Registration for Land Surveyors or, by a Decree of a Court of law:

A. Description of original monument and accessories and/or subsequent restoration:
K-1 UNKNOWN

B. Description of corner evidence found and/or method applied in restoring or re-establishing corner:
K-1 P.K. SET

C. Description of monument for corner and accessories established to perpetuate locating the position of the corner:
K-1 P.K.
N. 48°W. 60.6 P.K. WEST SIDE TELE. POLE GONE
N. 77°E. 62.15 P.K. SOUTH SIDE 20" TREE GONE
NORTH 91.96 1/2" BOLT WEST SIDE 36" OAK ?
S. 56°E 46.88 P.K. NORTH SIDE 48" ELM NO CLM GONE



SIGNED BY Oscar Boss DATE 8-23-72

SURVEYOR'S MICHIGAN REGISTRATION NO. 13574 (SEAL)

FOR STATE AND UNITED STATES AGENCIES:

SIGNED BY _____ DATE _____
CHIEF OF SURVEY PARTY

APPROVED AND SIGNED BY _____ DATE _____
MICHIGAN REGISTERED LAND SURVEYOR

(SEAL)

SURVEYOR'S MICHIGAN REGISTRATION NO. _____

LAND CORNER RECORDATION CERTIFICATE
 FILING REQUIREMENTS OF ACT 74, MICHIGAN P.A. 1970
 LIBER 216 55

FOR CORNERS OF--	LOCATED IN--	CORNER CODE NUMBER
1. PUBLIC LAND SURVEY <u>35</u>	T. <u>4</u> N. <u>2</u> E.	<u>I-13, J-13, K-13</u>
2. PROPERTY CONTROLLING IN SECTION _____	T. _____ N. _____ S., R. _____ W.	_____
3. MISCELLANEOUS PROPERTY IN SECTION _____	T. _____ N. _____ S., R. _____ W.	_____
4. LOT NO. _____	RECORDED PLAT _____	_____
5. PRIVATE CLAIMS _____	_____	_____

FILED

AUG 28 12 29 PM '72
 REGISTER OF DEEDS
Paul M. Lewis
 HIGHLAND COUNTY, MICH.

REGISTER OF DEEDS STAMP AND FILING NUMBER

I, OSCAR BOSS do hereby certify that under requirements of P.A. 74, Michigan P.A. of 1970, the corner points mentioned in lines 1 and 2 above (identified with circles on index code diagram—over) were, in a field survey on MAY 22 1972, established, re-established, monumented, re-monumented, recovered or restored as expressed below and in conformance with regulations and rules therefore as required in the current manual of survey instructions of the United States Department of the Interior, Bureau of Land Management or by a decree of a court of law. Furthermore, that the corner points mentioned in lines 3, 4 and 5 above were, in a field survey on _____ 19____, found, recovered, restored, established or re-established as expressed below and in conformance with the rules of the Michigan State Board of Registration for Land Surveyors or, by a Decree of a Court of law:

A. Description of original monument and accessories and/or subsequent restoration:

- I-13 - UNKNOWN
- J-13 - UNKNOWN
- K-13 - UNKNOWN

B. Description of corner evidence found and/or method applied in restoring or re-establishing corner:

- I-13 - 1/2" IRON FOUND
- J-13 - P.K. NAIL SET - SECTION SUBDIVISION
- K-13 - P.K. NAIL SET - SECTION SUBDIVISION

C. Description of monument for corner and accessories established to perpetuate locating the position of the corner:

- I-13 - 1/2" IRON FOUND
 WEST 54.14' NAIL NORTH SIDE TELEPHONE POLE
 S.18°E. 88.6' NAIL WEST SIDE 30" MAPLE
 S.10°W. 112.07' NAIL EAST SIDE 30" MAPLE
- J-13 - P.K. NAIL SET
 N. 35°E. 12.25' NAIL WEST SIDE 54" OAK
 N. 65°W. 100.11' NAIL SOUTH SIDE 24" MAPLE
 S. 70°W. 58.4' NAIL NORTH SIDE 20" MAPLE
- K-13 - P.K. NAIL SET
 N. 35°W. 48.2' P.K. WEST SIDE TELEPHONE POLE
 N. 13°E. 101.0' 1/2" BOLT WEST SIDE 30" OAK
 S. 71°E. 68.7' P.K. NORTH SIDE 48" ELM.



SIGNED BY Oscar Boss DATE 8-23-72

SURVEYOR'S MICHIGAN REGISTRATION NO. 13574 (SEAL)

FOR STATE AND UNITED STATES AGENCIES:

SIGNED BY _____ CHIEF OF SURVEY PARTY DATE _____

APPROVED AND SIGNED BY _____ MICHIGAN REGISTERED LAND SURVEYOR DATE _____ (SEAL)

SURVEYOR'S MICHIGAN REGISTRATION NO. _____

LAND CORNER RECORDATION CERTIFICATE

FILING REQUIREMENT OF ACT 74, MICH. P.A. 1970

REF 3 521

FOR CORNERS OF - LOCATED IN - CORNER CODE NUMBER

1. PUBLIC LAND SURVEY 11 T 3 N R 2 W I-3

2. PROPERTY CONTROL
ING IN SECTION T S R E

3. MISCELLANEOUS
PROPERTY IN SECTION T S R E

4. LOT NO. RECORDED PLAT

5. PRIVATE CLAIMS

FILED

FEB 3 8 39 AM '76

REGISTER OF DEEDS
Orville M. Lewis
INGHAM COUNTY, MICH

REGISTER OF DEEDS STAMP AND
FILING NUMBER

I, Oscar Boss do hereby certify that under requirements of P.A. 74, Michigan P.A. of 1970 the corner points mentioned in lines 1 and 2 above (identified with circles on index code diagram - over were in a field survey on October 17 1973 established, re-established, monumented, re-monumented, recovered or restored as expressed below and in conformance with regulations and rules therefore as required in the current manual of survey instructions of the United States Department of the Interior, Bureau of Land Management or by a decree of a court of law. Furthermore, that the corner points mentioned in lines 1 and 2 above were, in a field survey on 1973 found, recovered, restored, established or re-established as expressed below and in conformance with the rules of the Michigan State Board of Registration for Land Surveyors, by a Decree of a Court of Law:

A. Description of original monument and accessories and or subsequent restoration.

I-3 Unknown

B. Description of corner evidence found and or method applied in restoring or re-establishing corner

I-3 1" pipe fd.

C. Description of monument for corner and accessories established to perpetuate locating the position of the corner

I-3 NW CORNER, Sec. 11
SW corner house NE 111.7 ft.
NW corner house SE 90.75
iron fence post W. 34.4 ft.

SIGNED BY Oscar Boss

SURVEYOR'S MICHIGAN REGISTRATION NO. 13574

FOR STATE AND UNITED STATES AGENCIES:

DATE 1-29-76

SIGNED BY _____

APPROVED AND SIGNED BY _____

DATE _____

DATE _____

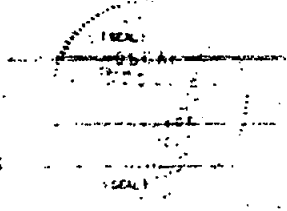

SURVEYOR'S MICHIGAN REGISTRATION NO. _____

INGHAM COUNTY-LEROY TWP.

LAND CORNER RECORDATION CERTIFICATE

FILING REQUIREMENT OF ACT 74, MICH. P.A.1970

FILED 1970

LIBER 5 PG 105

FILED

JAN 4 3 29 PM '79

REGISTER OF DEEDS

Paul Johnson

INGHAM COUNTY, MICH.

REGISTER OF DEEDS STAMP AND FILING NUMBER

74, Michigan P.A. of 1970, 1978, established, in accordance with regulations of the Department of the Interior, as mentioned in lines 3, 4 established or re-established for Land Surveyors or, by a

1869, (v.3, p.54). by J. H. Mullett,

form 280 dated

Form 280 grid map, dated 1963.

Instrument box #2.0' at spike in measured south #2645' and boat spike in

object crew.

of the corner:

.05'

.02'

1/2, R2W, South, 64.55'

78

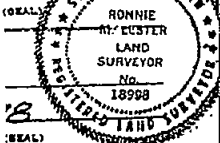

REGISTRATION, JAN. 28, 1971 REVISED MAY 14, 1978

LIBER 5 PG 1

FILED

JAN 4 3 29 PM

REGISTER OF DEEDS

Paul Johnson

INGHAM COUNTY, MICH.

REGISTER OF DEEDS STAMP AND FILING NUMBER

FOR CORNERS OF-- LOCATED IN-- CORNER CODE NUMBER
1. PUBLIC LAND SURVEY T. 3 N. R. 2 E. K-3
2. PROPERTY CONTROLLING IN SECTION T. S. R. E. W.
3. MISCELLANEOUS PROPERTY IN SECTION T. S. R. E. W.
4. LOT NO. RECORDED PLAT
5. PRIVATE CLAIMS

1. Rommie M. Lester, do hereby certify that under requirements of P.A. 74, Michigan P.A. of 1970, the corner points mentioned in lines 1 and 2 above were, in a field survey on Sept. 14, 1978, established, re-established, monumented, re-monumented, recovered or restored, as expressed below and in conformance with regulations and rules therefore as required in the current manual of survey instructions of the United States Department of the Interior, Bureau of Land Management or by a decree of a court of law. Furthermore, that the corner points mentioned in lines 3 and 5 above were, in a field survey on 1960, found, recovered, restored, established or re-established as expressed below and in conformance with the rules of the Michigan State Board of Registration for Land Surveyors or, by Decree of a Court of law:

A. Description of original monument and accessories and/or subsequent restoration:

K-3 Post set in original government survey by Joseph Wampler dated Dec. 1825. Corner identified as stone and brick in a survey by John McCreary, County Surveyor, dated Oct. 20-22, 1890 (v.3, p.228). Corner identified as stone and brick with iron beside, in a survey by Wm. Barryman, County Surveyor, no date given. Corner referred to in the Plat of Maple Ridge Subdivision, L.28, P.49 dated March 1, 1968 by Max F. Rogers, R.L.S. #6637. Corner identified as iron, stone and brick in Ingham County Road Commission records, revised grid map, 1960.

B. Description of corner or corners found and/or method applied in restoring or re-establishing corner:

K-3 Excavated a hole 6' x 10' to an average depth of 1.6' mostly north of the centerline of Pardee Road and on the fence line north and tree line south. Found 1/2" bent re-rod at road surface + 6.0' north of the centerline of Pardee Road. Found 0.8' x 0.5' arrowhead shaped stone with small stone at base, surrounded and supported by brick, with stone 2" below surface and brick 10" below surface in clay, + 4.5' north of the centerline of Pardee Road and on fence line north and tree line south. Accepted stone with brick as corner described in surveys noted above. Excavation conducted by Ingham County Survey and Remonumentation Project crew.

C. Description of monument for corner and accessories established to perpetuate locating the position of the corner:

K-3 SE Corner, Section 2, T3N-R2E Set 4" x 3/8" concrete monument with 1/2" x 3/8" re-rod and cap #18998, with concrete collar and cover at location of stone described above: Nail & tag, #18998, south side 22" Wild Cherry, NW, 70.83' Nail & tag, #18998, west side Wild Cherry cluster, NE, 30.40' Nail & tag, #18998, south side 14" Wild Cherry, NE, 48.22' SW corner of House #5020, at block foundation, SE, 109.92'

SIGNED BY Rommie M. Lester DATE Dec. 13, 1978

SURVEYOR'S MICHIGAN REGISTRATION NO. 18998

SIGNED AND APPROVED BY GARY D. LESTER DATE 11-15-78



Director, Ingham County Survey and Remonumentation Project

1491

FORM APPROVED BY MICHIGAN STATE BOARD OF REGISTRATION, JAN. 28, 1971 REVISED MAY 14, 1978

LAND CORNER RECORDATION CERTIFICATE
Filing Requirement of Act 74, Mich. P.A. 1970

FILED

For corners in

Ingham

(County)

Located In:

Corner Code ##

- 1. Public Land Survey T 3N R 2E I-2
T _____ R _____
T _____ R _____
T _____ R _____
- 2. Property Controlling S _____ T _____ R _____
in Section S _____ T _____ R _____
- 3. Miscellaneous S _____ T _____ R _____
Property in Sec. S _____ T _____ R _____

AUG 7 9 23 AM '89

REGISTER OF DEEDS

INGHAM COUNTY, MICH

Register of Deeds Stamp & File Number

- 4. Lot No. _____, Recorded Plat _____
- 5. Private Claims _____

Leroy Township

	A	B	C	D	E	F	G	H	I	J	K	L	M
2	6	5	4	3	2	1							
3													
4	7	8	9	10	11	12							
5													
6	18	17	16	15	14	13							
7													
8	19	20	21	22	23	24							
9													
10	30	29	28	27	26	25							
11													
12	31	32	33	34	35	36							
13													

I, James E. Stephens, in a field survey on August 2, 1989, do hereby certify that under requirements of P.A. 74, Michigan P.A. of 1970, the corner points mentioned in lines 1 and 2 above were in conformance with regulations and rules therefore as required in the current manual of survey instructions of the United States Department of the Interior, Bureau of Land Management or by a decree of a Court of Law and/or that the corner points mentioned in lines 3, 4 and 5 above were in conformance with the rules of the Michigan Board of Land Surveyors or by a Decree of a Court of Law; established, re-established, monumented, re-monumented, recovered, found as expressed below:

NOTE: Not more than 4 corners, all in the same town and range, may be recorded on this certificate.

A. Description of original monument and accessories and/or subsequent restoration:

Original monument and accessories were not found.

B. Description of corner evidence found and/or method applied in restoring or reestablishing corner:

Found 1/2 inch diameter iron rod in centerline of Webberville Road on the projection of a fence line to the West.

C. Description of monument for corner and accessories established to perpetuate locating the position of the corner:

Iron rod was left in position with the following witnesses:
Found survey tag/number 29238 in corner fence post West 33.45 feet.
Found survey tag/number 18998 in utility pole West 63.65 feet.
Set tag/number 16053 in East side of Elm tree cluster N25°E 106.00 feet.
Set tag/number 16053 in West side of 10' Elm tree S30°E 72.40 feet.



Signed by James E. Stephens Date August 3, 1989
Surveyor's Michigan License No. 16053

LAND CORNER RECORDATION CERTIFICATE
Filing Requirement of Act 74, Mich. P.A. 1970

For corners in

Ingham

(County)

Located In:

Corner Code #

- | | | | | | |
|------------------------------------|---|----|---|----|-----|
| 1. Public Land Survey | T | 3N | R | 2E | I-3 |
| | T | | R | | |
| | T | | R | | |
| | T | | R | | |
| 2. Property Controlling in Section | S | | T | | |
| | S | | T | | |
| 3. Miscellaneous Property in Sec. | S | | T | | |
| | S | | T | | |
| 4. Lot No. Recorded Plat | | | | | |
| 5. Private Claims | | | | | |

FILED

AUG 7 9 23 AM '89

REC'D DEEDS

Register of Deeds Stamp & File Number.

Leroy Township

	A	B	C	D	E	F	G	H	I	J	K	L	M
2	6	5	4	3	2	1							
3													
4	7	8	9	10	11	12							
5													
6	16	17	16	15	14	13							
7													
8	19	20	21	22	23	24							
9													
10	30	29	28	27	26	25							
11													
12	31	32	33	34	35	36							
13													

I, James E. Stephens, in a field survey on August 2, 1989, do hereby certify that under requirements of P.A. 74, Michigan P.A. of 1970, the corner points mentioned in lines 1 and 2 above were in conformance with regulations and rules therefore as required in the current manual of survey instructions of the United States Department of the Interior, Bureau of Land Management or by a decree of a Court of Law and/or that the corner points mentioned in lines 3, 4 and 5 above were in conformance with the rules of the Michigan Board of Land Surveyors or by a Decree of a Court of Law, established, re-established, monumented, re-monumented, recovered, found as expressed below.

NOTE: Not more than 4 corners, all in the same town and range, may be recorded on this certificate.

A. Description of original monument and accessories and/or subsequent restoration.

Original monument and accessories were not found.

B. Description of corner evidence found and/or method applied in restoring or reestablishing corner:

Found 3/4 inch pipe in intersection of Webberville Road and Pardee Roads.

This certificate is being recorded to up-date witness information on an earlier certificate recorded in Liber 3, Page 521.

C. Description of monument for corner and accessories established to perpetuate locating the position of the corner.

Iron pipe was left in position with the following witnesses:
 Found survey tag/number 29238 in utility pole West 32.44 feet.
 Found survey tag/number 29238 in 30 inch Maple tree S30°E 69.55 feet.
 Found survey tag/number 29238 in 30 inch Maple tree S40°W 95.40 feet.
 NW corner of house # 2996 S45°E 139.35 feet.



Signed by

James E. Stephens
 Surveyor's Michigan License No. 16053

Date August 3, 1989

2287