

COUNTY SURVEYOR'S RECORD,

TOWN Four NORTH, RANGE One East, MERIDIAN OF MICHIGAN.

Sec 20

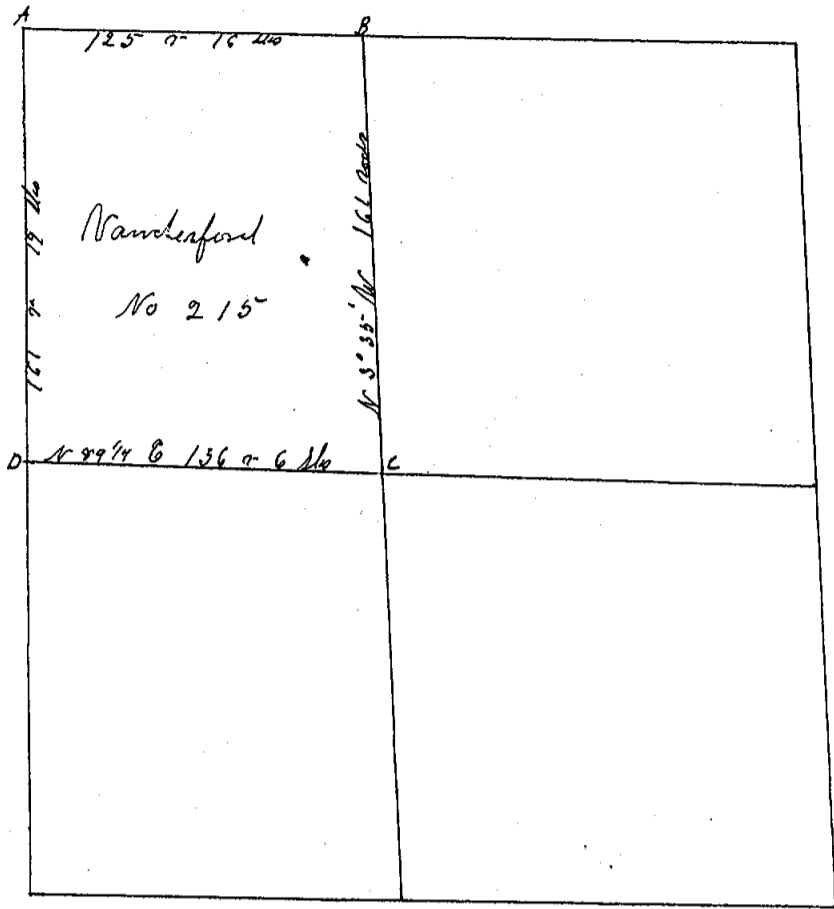

P 187 Oct 1

TOWN One NORTH, RANGE One East, MERIDIAN OF MICHIGAN.

- 1
- 2
- 3
- 4
- 5
- 6
- 7
- 8
- 9
- 10
- 11
- 12
- 13
- 14
- 15
- 16
- 17
- 18
- 19

24  
25  
W Oak 14 m N 35° E 51' 1/2"  
A W Oak 12 m N 79° E 51' 1/2"  
W Oak 9 m S 49° W 12' 1/2"  
B 3 dm 9 m S 69° E 9' 1/2"  
R Oak 16 m S 35° W 29' 1/2"  
C Cherry 12 m N 76° W 21' 1/2"  
W Oak 15 m N 56° E 79' 1/2"  
D 14 Oak 16 m S 75° 3/4 W 118' 1/2"  
1928 found stone-brick  
83' N.W. 10" cherry 16' deep  
26' E anchor post  
32' E rd "

## INGHAM COUNTY, MICHIGAN.

TOWN ~~Iron~~ NORTH, RANGE ~~One~~ East, MERIDIAN OF MICHIGAN.

Run by the true Meridian Nov 3<sup>rd</sup> &  
Surveyed and Recorded Oct 8<sup>th</sup> 1842  
by A Jackson Co Surveyor

STATE OF MICHIGAN, }  
COUNTY OF INGHAM, } ss.

Received for Record this 5th day of August, A. D. 1901, at 9 o'clock A. M.

COPY OF MINUTES OF SURVEY.

per F. A. Lester  
L. J. Lester Deputy Register of Deeds.

SECTION 12, Town 4 North, Range 10 West, Meridian of Michigan.

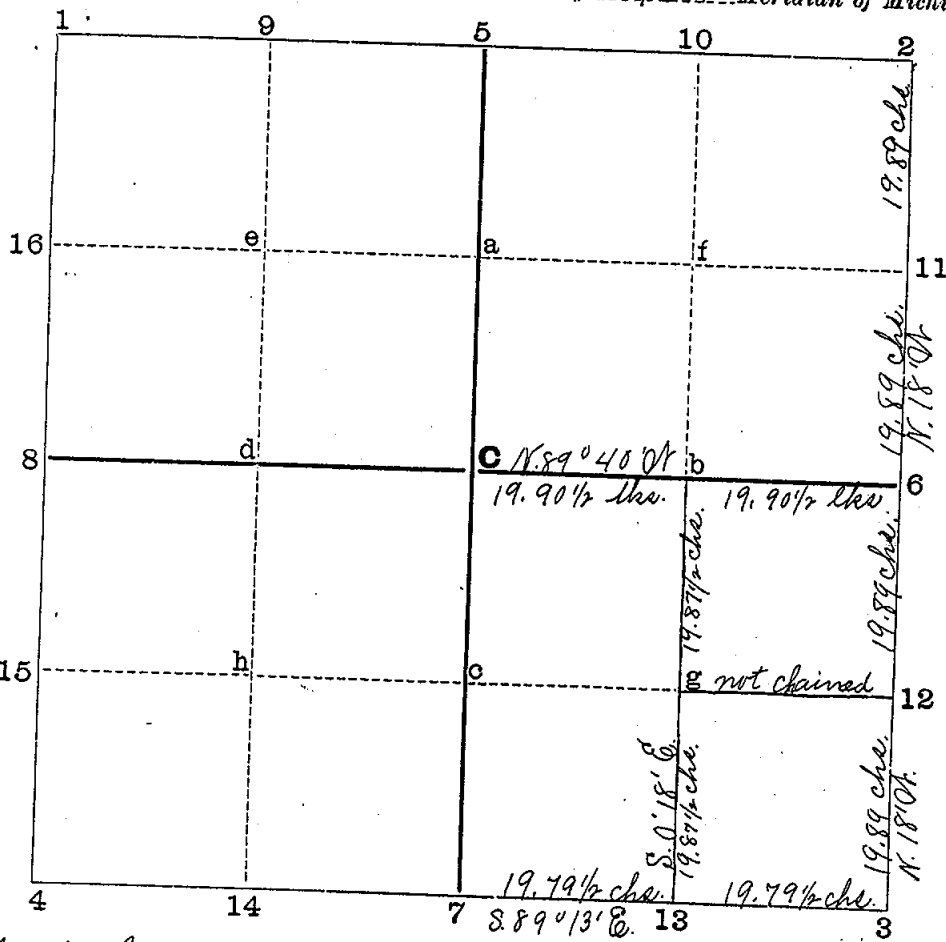

- 1 C. P. of brick, set + marked stone with brick f. rr. W. Oak 24, N. 84° W. 6 1/2 lks.
- 2 C. P. of resurvey f. rr. B. Walnut 3 - N. 10° E. 45 l.
- 3 C. P. of resurvey and C. B. of same good. set mower trace 2 1/2° long.
- 4 plow point and brick C. B. of resurvey by Mullett.
- 5
- 6 Set by statute, stake marked stone & 3/4' sq. iron, 3° long f. rr.
- 7 bars Swp. Oak 10, S 18 1/2° E. 24 1/2 l. and W. Oak 10, N 13 1/4° W. 92 l.
- 8 C. P. of and old bearing good. Set mower pitman.
- 9
- 10
- 11 Set post and c + marked stone f. rr. Swp. W. Oak 7 - S 72 1/2° W. 48 1/2 l.
- 12 Set iron 7/8' d. rod 8° long with stake, no trees.
- 13 Set iron brace from old cart, 2 1/4° long & + marked stone f. rr.
- 14 R. Oak. 15, N. 2 1/4° W. 114 l.
- 15
- 16

MINUTES OF SURVEY (Concluded).

a  
b  
c  
d  
e  
f  
g  
h  
K Posts on K Line  
Centers of K Sections

Not marked.

Set iron fence post 7' long for corner. No trees near

Magnetic variation of 10' West was allowed.

STATE OF MICHIGAN,

COUNTY OF INGHAM,

SS.

C. A. Calkins

County Surveyor of said County.

Do Hereby Certify that I did, on the application of Isaac Paper survey the S. E. 1/4 of S. E. 1/4 of 1/4

Section 12 in the Township of Meridian, Town 4 North, Range 10 East

in July 18th and 19th - A.D. 1901  
by Isaac Paper and the following persons acted as chainmen, first being duly sworn, to-wit: Albert Smith and Edward Piper

And I Further Certify that I have compared the foregoing copy with the original minutes made by me at the time of the survey, and that it is a full and true copy of the minutes of such survey, which minutes give the magnetic variation at the initial point of the survey.

C. A. Calkins

County Surveyor.

STATE OF MICHIGAN, }  
COUNTY OF INGHAM, } ss.

Received for Record this \_\_\_\_\_ day of \_\_\_\_\_, A. D. 1\_\_\_\_\_, at \_\_\_\_\_ o'clock \_\_\_\_\_ M.  
\_\_\_\_\_, Register of Deeds.

COPY OF MINUTES OF SURVEY.

SECTION 14, Town 4 North, Range 14 Meridian of Michigan.

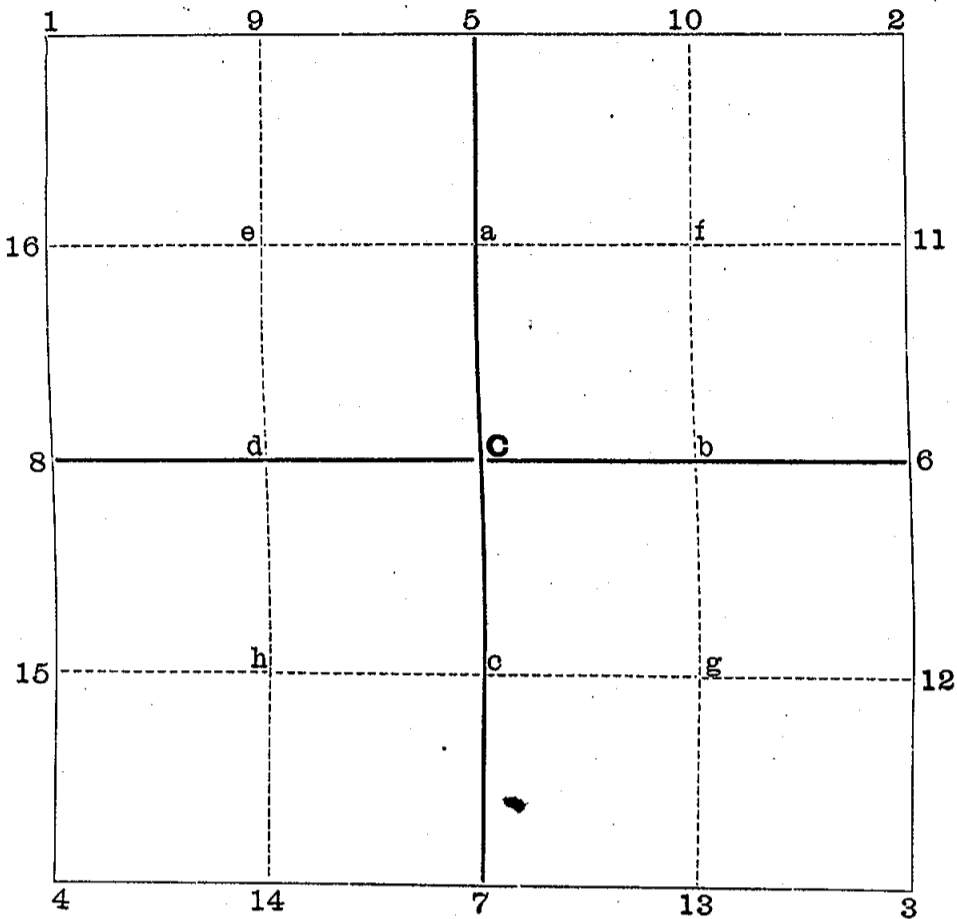

C

- 1
- 2 Cement Slab.
- 3 Post
- 4
- 5
- 6 Gas pipe and tile.
- 7 Half Cylinder Brick Stone
- 8
- 9
- 10
- 11
- 12 Post in Ditch.
- 13 Gas pipe - Poplar 12" East 4 1/4 lbs.
- 14
- 15
- 16

MINUTES OF SURVEY [Concluded].

a  
 b Gas pipe.  
 c Gas pipe Elm 10" S 45 W 34 lbs - Elm 3" N 49 W 44 lbs.  
 d  
 e  
 f  
 g Gas pipe.  
 h

Corners 7-3-12-C-d and 2 were found and perpetuated  
 Corner # 6 was located at the intersection of lines 2-3 and  
 e-b and a gas pipe set. Corners b-c-g and 13  
 were marked.

D. Foster Surveyor

STATE OF MICHIGAN,  
 COUNTY OF INGHAM,

} ss. I, *R. J. Robb*, County Surveyor of said County,  
 Do Hereby Certify that I did, on the application of

*Geo B Van Etta*

Section 14 in the Township of Meridian, Town 4 North, Range 14  
Apr 3 1908 survey SW 1/4  
 and the following persons acted as chainmen, first being duly sworn, to-wit:  
Still Kirkpatrick & C. Bert

And I Further Certify that I have compared the foregoing copy with the original minutes made by me at the time of the survey, and that it is a full and true copy of the minutes of such survey, which minutes give the magnetic variation at the initial point of the survey.

\_\_\_\_\_  
*R. J. Robb* County Surveyor.

COUNTY SURVEYOR'S RECORD,

TOWN 4 NORTH, RANGE 1 West, MERIDIAN OF MICHIGAN.

SEC. 14

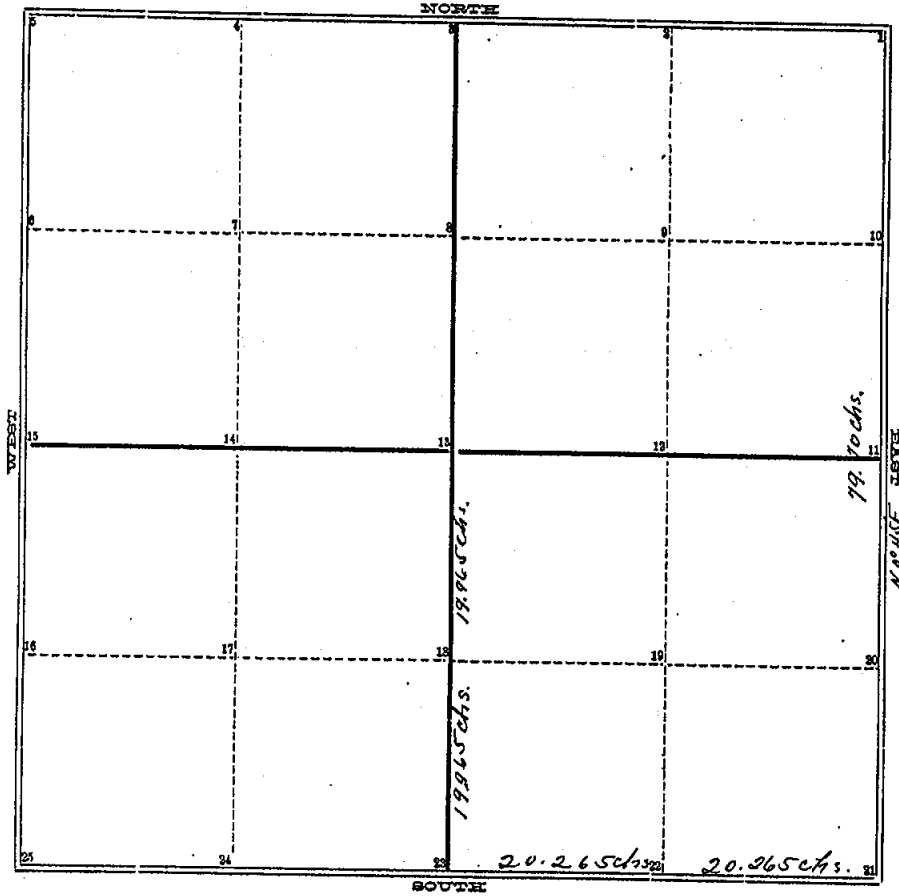

TOWN \_\_\_\_\_ NORTH, RANGE \_\_\_\_\_, MERIDIAN OF MICHIGAN.

- 1 Cement Slab. 24
- 2 25
- 3
- 4
- 5
- 6
- 7
- 8
- 9
- 10
- ✓ 11 Gas pipe & tile.
- ✓ 12 Gas pipe
- 13
- 14
- 15
- 16
- 17
- 18 Gas pipe Elm 10" S45°W 34 lks  
" 8" N49°W 44 "
- ✓ 19 Gas pipe.
- ✓ 20 Post in ditch
- ✓ 21 Post  
1 1/2 "
- ✓ 22 Gas pipe Poplar 12' East 4 1/2 lks.  
WELL BRICK
- 23 CYLINDER STONE

WINGHAM COUNTY, MICHIGAN.

262

TOWN 4 NORTH, RANGE 1 West, MERIDIAN OF MICHIGAN.

Survey of the S.W. 1/4 of Section 14 T47 R1W for  
Grs. B. Van Alst.

Will ~~Kirk~~ Kirkpatrick } Surveyor  
C. Betts } Chairman  
H. Foster Survey Marker.

Corners 23, 21, 20, 13, 14 and 1 were found and perpetuated  
Corner 11 was located at the intersection of lines 1-~~21~~ 21  
and 13-14 and a gas pipe set. Corners 17, 18, 19 and  
22 were marked.

Surveyed Apr. 3, 1908  
Recorded May 5, 1908

P. J. Robb  
Co. Surveyor.