

22.77  
22.77  
22.77

<p>21' 82' 73'</p>	<p>1" Iron 24" Walnut E.NE 75.5' SW.cor.house N.E. 93.2' 18" Walnut WNW 46.37'</p>	<p>Iron, stone, brick (1936) 5" Oak N.E. 31.3' 22" Walnut NW 42.0' 3" Walnut SW 61.6'</p>			
----------------------------	--	---	--	--	--

<p>0' 0.14' 35'</p>	3	2			
-----------------------------	---	---	--	--	--

<p>0.23' 95' 72'</p>	10				12
------------------------------	----	--	--	--	----

		<p>544.5'</p>	<p>1/2" Iron bar SW.cor.house N.E. 95.8' NW.cor.house S.E. 70.5'</p>		
--	--	---------------	--	--	--

15		14	<p>1-1/4" Iron, stone Anch. post W. 24.1' 5" Elm WNW 39.3' 4" Elm N.N.E. 79.1' 19" Elm SW 45.2'</p>		13
----	--	----	---	--	----

<p>69' 75' 40' 50'</p>			<p>1" Pipe, brick tw. 12" Oak W. 25.8' 20" Oak E.N.E. 26.2' 12" Oak E. 20.5' 12" Oak N.E. 81.8' 1-1/8" Iron E. 33.0'</p>		
------------------------------------	--	--	--	--	--

22	<p>1969) 6.50' 8.37' 10' 85'</p>	23	<p>1-1/2" Pipe (M.D.S.H. 1967) 23" Oak N.27°W 44.61' 32" Oak S.84°W 16.70' 36" Oak E 39.49'</p>	<p>1321.37'</p>	24
----	--	----	---	-----------------	----

	<p>Wood stake on E &amp; W fence line, 851.5' N. of C of road along W. end of Spröss' barn.</p>	<p>Stone 18" Maple SW 53.5' 12" Cherry S.E. 58.5' 6" Apple N.W. 40.0'</p>	<p>2640.24'</p>	<p>1" Iron (M.D.S.H. 1967) No natural witnesses available. 3/4" Rod (M.D.S.H. 1967) 19" Oak S.58°E. 38.48' 26" Maple N.88°E. 33.53' 18" tw. Poplar N.27°E. 66.25' Prop. Iron E. 33.00'</p>	<p>1320.76'</p> <p>1/2" Iron (M.D.S.H. 1967) 24" Maple W. 22.88' P.P. N.50°E. 37.80' 24" Maple S.18°E. 72.34'</p>
--	---	---	-----------------	--	---

	<p>Stone 10" Oak N.E. 14.8' 18" Oak N.W. 22.0' 12" Oak N. 24.5'</p>	<p>2634.90'</p> <p>1-1/2" Iron (M.D.S.H. 1967) 14" Oak N.40°W 52.23' P.P. W. 44.20' 10" Oak S.65°E. 8.26' Conc. Mon. E. 33.00'</p>	<p>1321.44'</p> <p>1-1/2" Iron (M.D.S.H. 1967) 4" Hickory N. 19.80' 6" Cherry E. 41.13' Base NW. Leg Tower S.24°W 51.60'</p>	<p>1320.76'</p>	<p>Stone (M.D.S.H. 1967) 14" Cherry N.05°W 10.57' 17" Basswood N.70°W.30.70' 10" Hickory S.78°E. 9.86' 24" Ash S.20°W. 12.21'</p>
--	---	--	--	-----------------	---

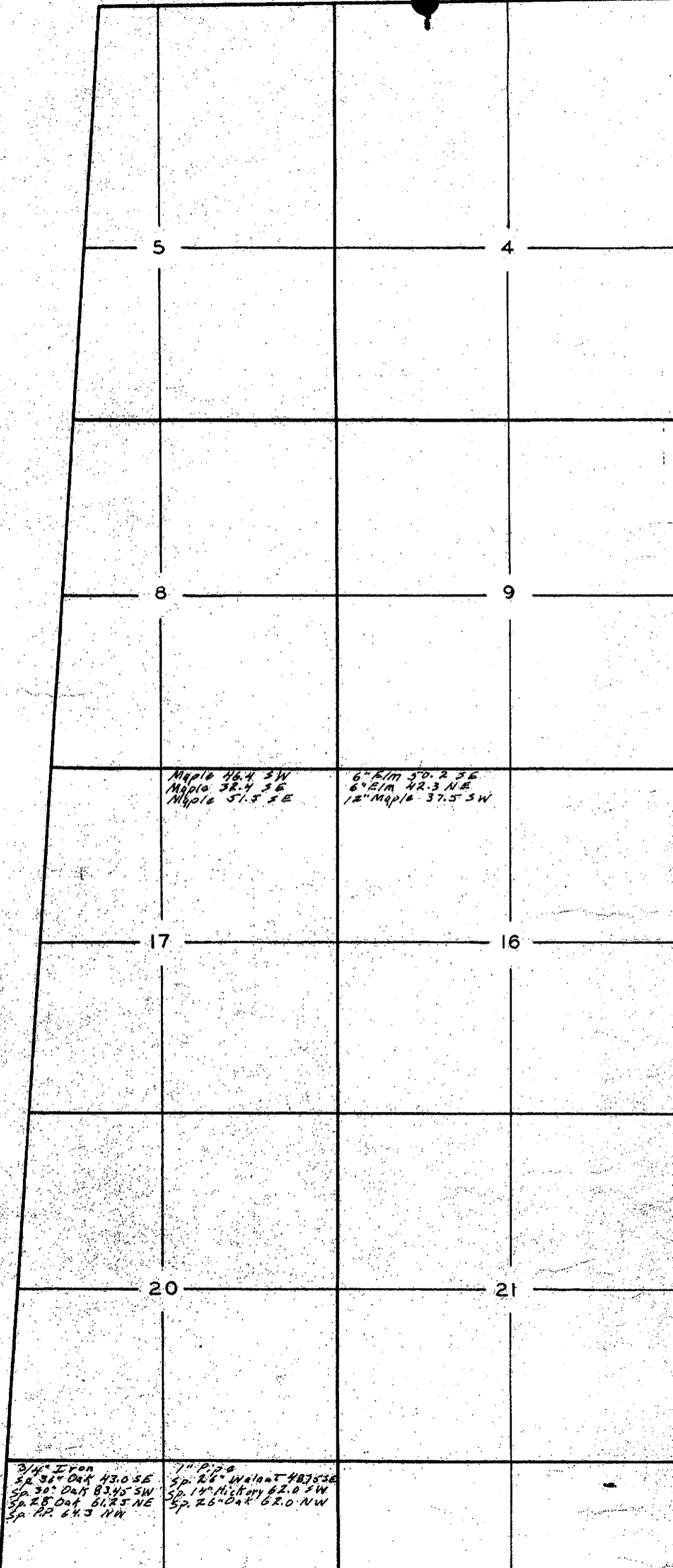

5

4

8

9

17

16

20

21

Maple 46.4 SW  
Maple 38.4 SE  
Maple 51.5 SE

6" Elm 50.2 SE  
6" Elm 42.3 NE  
12" Maple 37.5 SW

3 1/4" Iron  
Sp. 28" Oak 43.0 SE  
Sp. 30" Oak 83.45 SW  
Sp. 28" Oak 61.75 NE  
Sp. 12" 64.3 NW

1" P. 2.0  
Sp. 24" Walnut 48.5 SE  
Sp. 14" Hickory 62.0 SW  
Sp. 26" Oak 62.0 NW