

COUNTY SURVEYOR'S RECORD,

TOWN Three NORTH, RANGE One East, MERIDIAN OF MICHIGAN.

SEC. 24

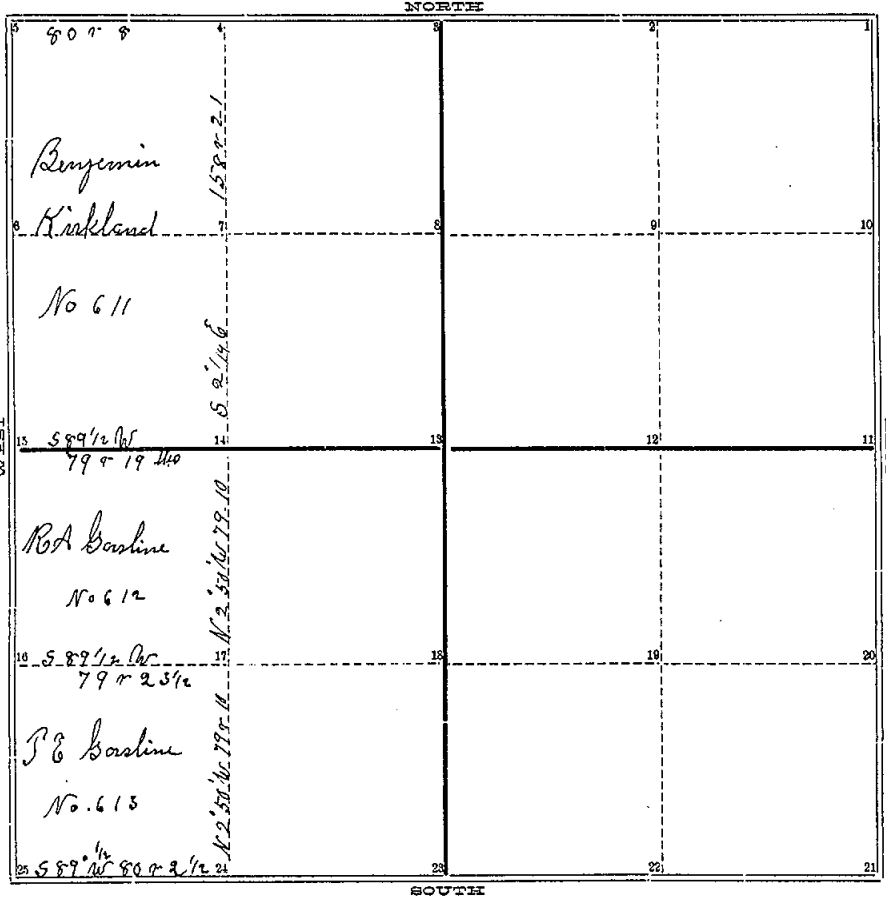

TOWN Three NORTH, RANGE One East, MERIDIAN OF MICHIGAN.

- 1
 - 2
 - 3
 - 4
 - 5
 - 6
 - 7
 - 8
 - 9
 - 10
 - 11
 - 12
 - 13
 - 14
 - 15
 - 16
 - 17
 - 18
 - 19
 - 20
 - 21
- Bush 13 S 79 E 15 1/2
 G 24 D 6.14 N 81 1/2 W 32
 Bush 11 corner 1/2
 H 25
 Jan 5 S 55 1/4 W 42
 D O 3 S 25 E 45
 Bush 14 N 37 1/4 E 3 1/2
 a 5 D O 21 S 42 1/2 W 39 1/2
 Bush 12 N 65 W 20
 c 14 D O 14 S 85 E 29
 Bush 7 S 56 E 3
 d 15 Sugar 10 N 15 1/2 E 15
 W 1/2 14 S 15 E 5 1/2
 E 16 Sugar 50 N 7 1/2 W 25
 W 1/2 12 S 74 1/2 W 51
 F 17 Bush 20 S 25 E 39

INGHAM COUNTY, MICHIGAN.

TOWN ~~Three~~ NORTH, RANGE ~~One~~ East, MERIDIAN OF MICHIGAN.

Born by the true Meridian Var 2° 50' E
Surveyed and Recorded Jan 31 at 1863
by A Jackson County Surveyor

Note. at No. 5. Section corner. old witness gone. Stone set by me when Jackson's bearings
were taken in 1871. To day April 16 - 1888 found roots of Jackson's bearings from stone
took new bearing 5 upon 11 N 11 1/2 E 184 lts bearing 8 S 12 E 220 lts

At No 15 for 14 post between 23 + 24 No witness or Post found set stone 1/2 way between
No 5 and 25 in straight line 39 chains + 97 lts from each corner April 16 1888. J H Mullett

COUNTY SURVEYOR'S RECORD,

TOWN Shu NORTH, RANGE One East, MERIDIAN OF MICHIGAN.

Book 3
P 110

Section 24

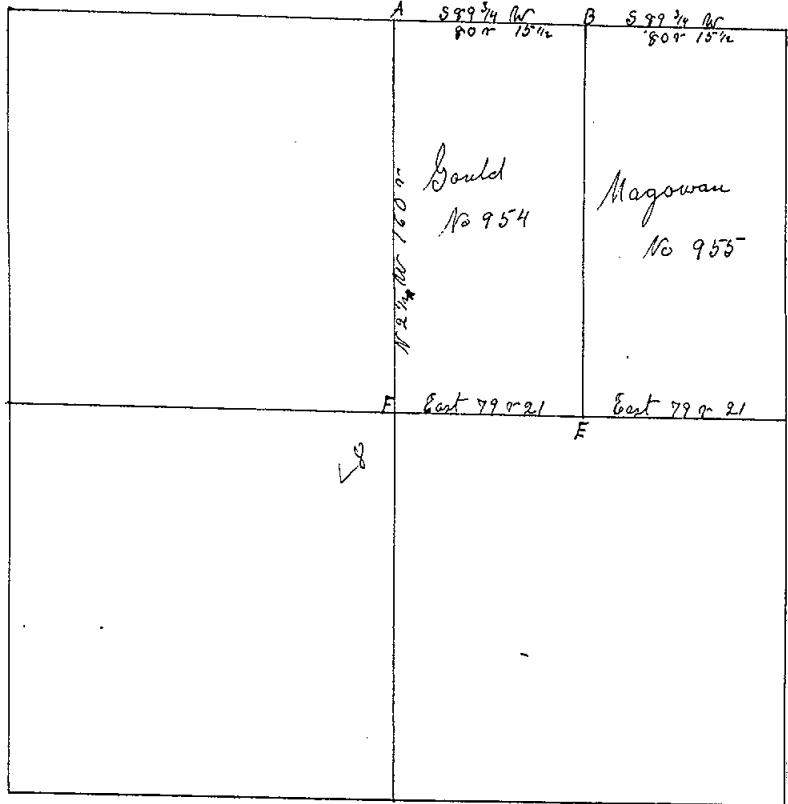

Pro 1/2

TOWN Shu NORTH, RANGE One East, MERIDIAN OF MICHIGAN.

- 1
- 2
- 3
- 4
- 5
- 6
- 7
- 8
- 9
- 10
- 11
- 12
- 13
- 14
- 15
- 16
- 17
- 18
- 19
- 20

24
 25
 A Bush 15 S 55 1/2 W 5 17
 B 3 1/2 S 57 1/2 W 10 21
 B 13 24 N 5 1/2 E 17
 C 11 N 53 3/4 W 46 1/2
 D 12 1/2 N 12 1/2 W 17
 E 13 1/2 N 50 1/2 E 27
 F 11 1/2 N 2 1/2 W 10 17
 G 15 1/2 N 1/2 W 100
 H 17 1/2 N 53 1/2 W 10 17
 I 12 1/2 N 17 1/2 E 15 17
 J 11 1/2 N 2 1/2 W 10 17
 K 11 1/2 N 57 1/2 W 12 17

Run By the True Meridian Var $3\frac{1}{2}^{\circ}E$
Surveyed and Recorded May 25th '56
By A. Jackson, Sr. Surveyor.

Note at A old bearing for stump
instead of New bearing Book 10 Page
28
Stone and Briel J. L. Mullett Jan 16 1870

Book 3, P 10

Transcribed 9.29.08 mmm

A - N/W Cor. (L-7)

TOWN *of* ~~...~~ NORTH, RANGE *...* ~~...~~ East, MERIDIAN OF MICHIGAN.

Run by Mr. ...

Surveyed and ...

My ...

Note - at ...

Shore and ...