

Township N. III North, Range N. I East Mon. / Mic. Ter.

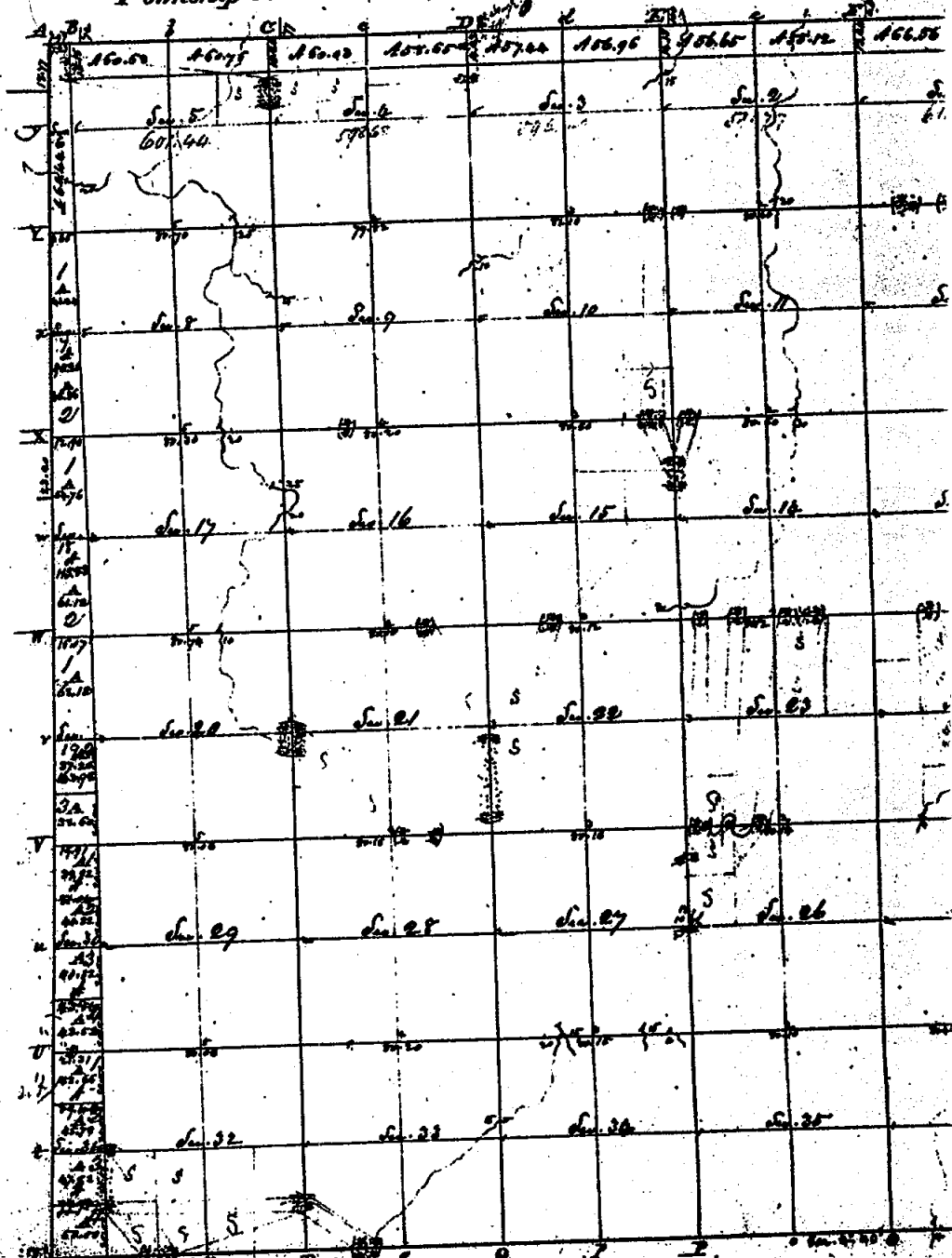

Surveyed in February 1826 - by Joseph Mansfield Esq.

West. 1977

Range N. I. East Mer. (Mic. Ton.)

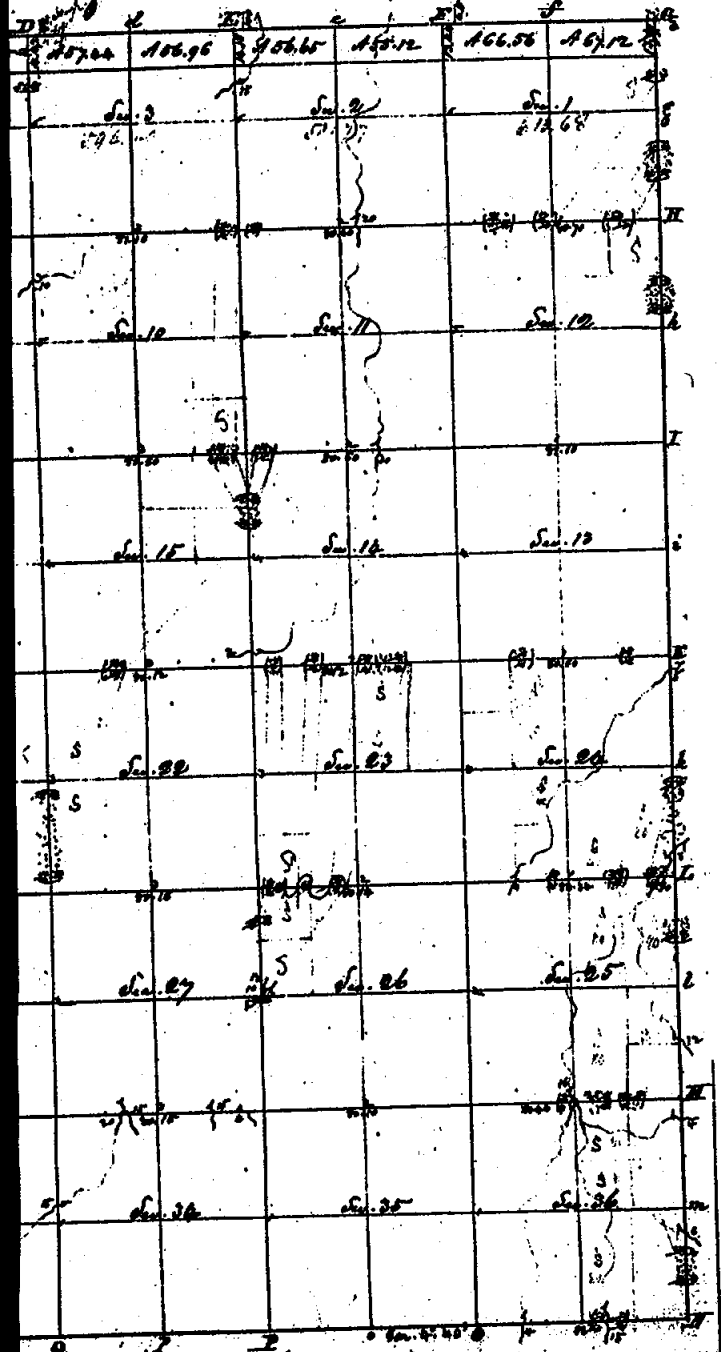

Sections	Area	Value
Nx N6 1	67	12
Sx	50	
Nx N7	66	56
Sx	50	
Nx N8 2	320	
Sx	50	10
Nx N7	56	65
Sx	50	
Sx	320	
Nx N8 3	56	96
Sx	50	
Nx N7	57	44
Sx	50	
Sx	320	
Nx N6 4	58	65
Sx	50	
Nx N7	60	02
Sx	50	
Sx	320	
Nx N6 5	60	76
Sx	50	
Nx N7	60	68
Sx	50	
Sx	320	
Sec 6	63	04
7	90	20
8	540	
9	540	
10	540	
11	540	
12	540	
13	540	
14	540	
15	540	
16	540	
17	540	
18	115	88
19	143	92
20	540	
21	540	
22	540	
23	540	
24	540	
25	540	
26	540	
27	540	
28	540	
29	540	
Nx 30	81	86
Sx	83	84
Nx 31	89	44
Sx	97	92
32	640	
33	640	
34	640	
35	640	
36	640	
Total Area	15,775	65

3  
29-32  
29-32

by Joseph Wampler Esq. → 2.920 Est

Total 15,775 65